



Wolfgang Preinfalk GmbH

Drive Solutions for offshore and harbour





St. Ingbert - Germany

About us

We are an independent solution specialist for gear technology, gearboxes and complete drive units. Almost all of the work steps in the manufacturing process are performed in-house at our headquarters in St. Ingbert.

Expertise

- Consulting and engineering
- Procurement of high-quality, certified material
- Manufacturing, assembly and test bench run
- Installation, instruction and training

Certification

- Certified according to DIN ISO 9001: 2008
- Cooperation with all major classification societies: ABS, DNV GL, LR, BV, CCS, RS
- Certification for use in hazardous locations: ATEX, MA, GOST

Service & After Sales

- Experienced technicians active worldwide
- Inspection and damage diagnostics
- Preventive solutions
- Upgrades and modifications
- Spare parts stockage

Your benefit

- Independent R&D department
- State of the art machinery
- Use of material with European certificate of origin
- High requirements for material quality of casted components, shafts and gearing components
- Own heat treatment facility
- Usage of FAG, SKF and NSK quality bearings
- Temper etching test
- Worldwide sales and service network



Our business segments

Gear manufacturing

- Mining
- Harbour
- Steel
- Offshore
- Power plant
- Wind
- Industry

Tooth gear production for OEM

- Wind energy
- Engines for vessels

Spare parts

- Own- and external gears
- Longwall hydraulics
- Jetting / cooling

High-pressure pump systems

- Industry
- Longwall hydraulics
- Jetting / cooling

Drive systems

Modular structured system solutions:

- Gears
- Coupling/brake system
- Motor

Video
company
walk



Offshore

Jack-up vessel
Tidal power plant

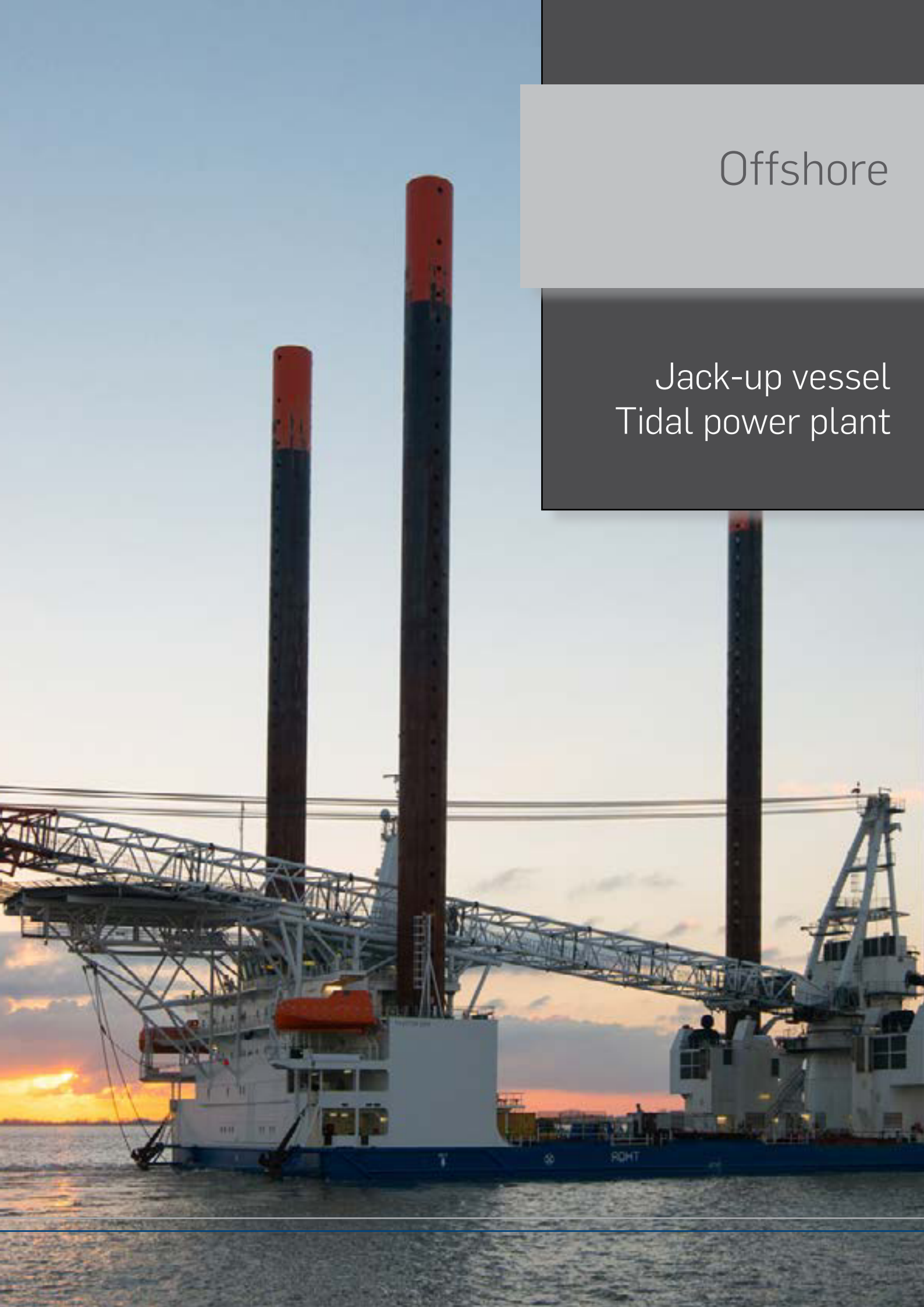

offshore

Jack-up vessels

3S 415 Z x 110 So

Jack-up gearbox



References

Supplied to customers in

- Germany

For more detailed information
please contact our sales agent.

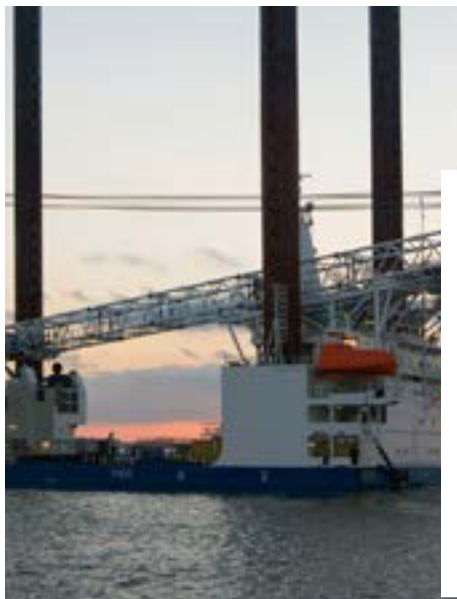

Technical data

Input speed	n1	3000 min ⁻¹
Output speed	n2	27,2 min ⁻¹
Ratio	i	110 :1
Output torque	T2	0 kNm
Weight		1913 kg



offshore

Tidal power plant

2SP 215 x 90

Gearbox for turbines

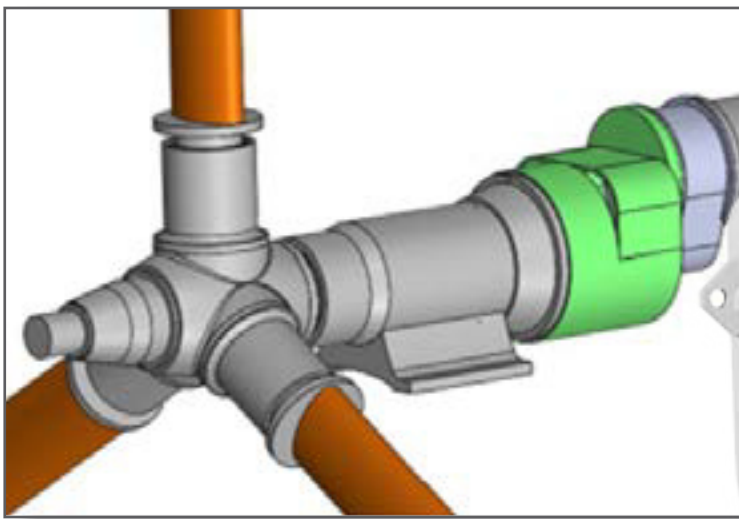

Technical data

Rated power	P	313 kW
Input speed	n1	28,6 min ⁻¹
Output speed	n2	2574 min ⁻¹
Ratio	i	90 :1
Output torque	T2	1,17 kNm
Input torque	T1	105 kNm
Weight		2450 kg



References

Supplied to customers in

- Germany

For more detailed information please contact our sales agent.

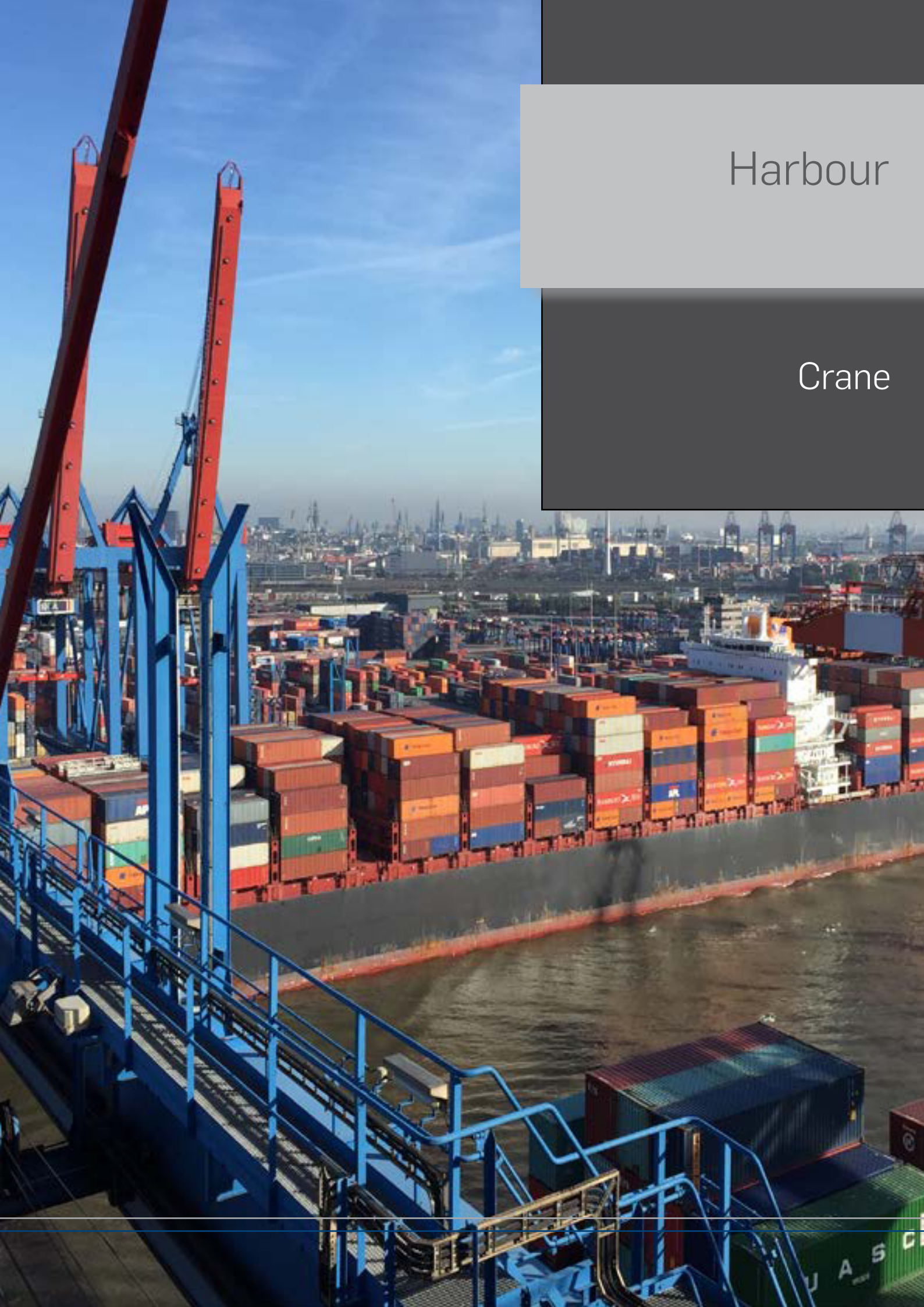

Harbour

Crane



harbour

References

- Drive gearbox 2020 for gantry crane
PW type: K2SH210x58

36 pcs. for each of left & right output.

P= 18,5 kW / $n_1 = 1.450 \text{ min}^{-1}$ / Ratio $i = 58,15$

- Trolley travelling gearbox 2420 for container crane
PW type: K1SH200x16

6 pcs. for each of left & right output.

P= 66 kW / $n_1 = 1.510 \text{ min}^{-1}$ / Ratio $i = 15,875$

- Hoist gearbox 3020 for container crane
PW type: 3SZ490x32

3 pcs. for each of left & right output.

P= 300 kW / $n_1 = 840 \text{ min}^{-1}$ / Ratio $i = 31,478$

- Hoist gearbox 3420 for container crane
PW type: 3SH520x63

3 pcs. for each of left & right output

P= 230 kW / $n_1 = 1.060 \text{ min}^{-1}$ / Ratio $i = 63,234$

Supplied to customers in

- Germany

For more detailed information
please contact our sales agent.

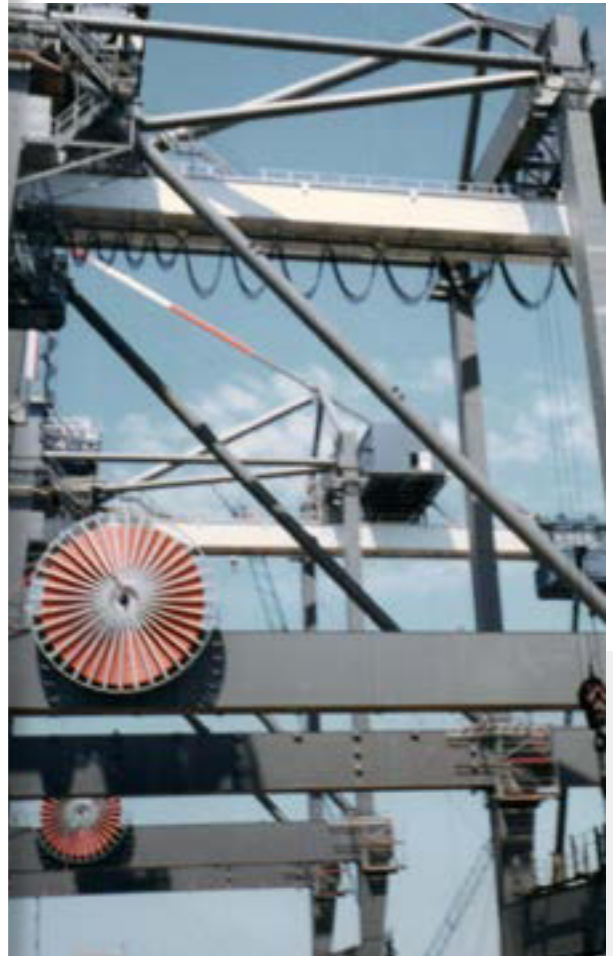



Wolfgang Preinfalk GmbH
Im Oberen Werk 4
66386 St. Ingbert
Germany
Tel.: +49 6894 3101-0
sales@preinfalk.de
www.preinfalk.de
